

ECO	STAT	DATE	DESCRIPTION	DATE	DRW	APPD
GP	00					
A		30SEP2003	RELEASE PER ECO-05-009687		DDR	MY
A1		11NOV2003	REV PER ECO-05-012912		BC	MY
B		01DEC2004	REVISED PER ECR-06-028078		ST	SY

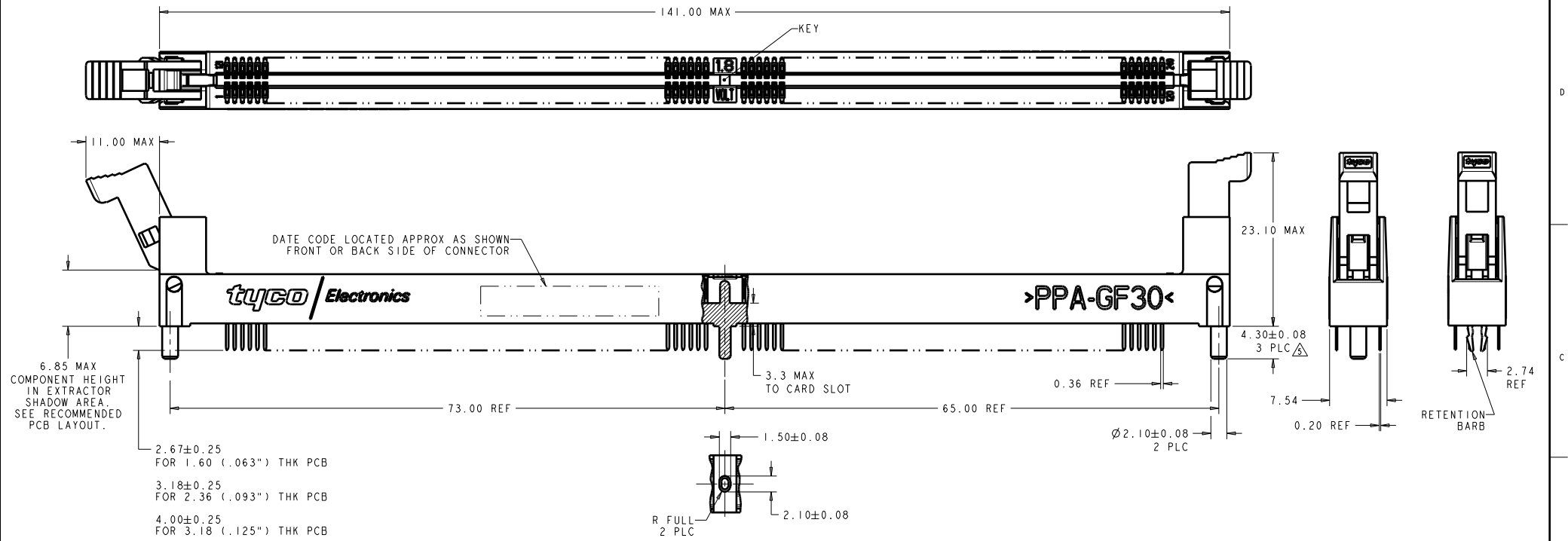

- MATERIALS:**
- HOUSING: HIGH TEMPERATURE NYLON, BLACK, UL94 V-0
 - EXTRACTOR: HIGH TEMPERATURE THERMOPLASTIC
 - CONTACTS: COPPER ALLOY
 - RETENTION BARB: STAINLESS STEEL
- INTERFACE FINISH:**
- (1) 0.00076 MIN THK GOLD OVER 0.00127 MIN THK NICKEL
 - (2) 0.00038 MIN THK GOLD OVER 0.00127 MIN THK NICKEL
 - (3) 0.00008 MIN THK GOLD OVER 0.00127 MIN THK NICKEL
- RIGHT HOLE IS GLOBAL D-E ORIGIN FOR ALL POSITIONAL TOLERANCES. LEFT AND RIGHT NON-PLATED THRU HOLES ESTABLISH -E-.**
- FINISHED HOLE SIZE. 0.15 MAXIMUM ANULAR RING.
 - RETENTION BARB MAY BE SPECIFIED IN PLACE OF PEGS (3 PLC). DIMENSION INDICATED WOULD THEN BE 4.00 MAX.
 - KEEP OUT ZONE.
 - KEEP OUT AREA RESERVED FOR SOCKET EXTRACTORS, BOTH ENDS.
 - SOLDERTAIL FINISH: 0.00300 MIN THK BRIGHT TIN-LEAD OVER 0.00127 MIN. THK NICKEL.
 - SOLDERTAIL FINISH: 0.00300 MIN THK MATTE TIN OVER 0.00127 MIN. THK NICKEL.
 - LED LOCATION AS APPLICABLE PER CUSTOMER.
 - QUALIFY TO TYCO DESIGN OBJECTIVES 108-2111-1.
 - QUALIFY TO TYCO DESIGN OBJECTIVES 108-2111-2.
 - DATUM [-F-] IS CONNECTOR SIDE SURFACE OF PCB.

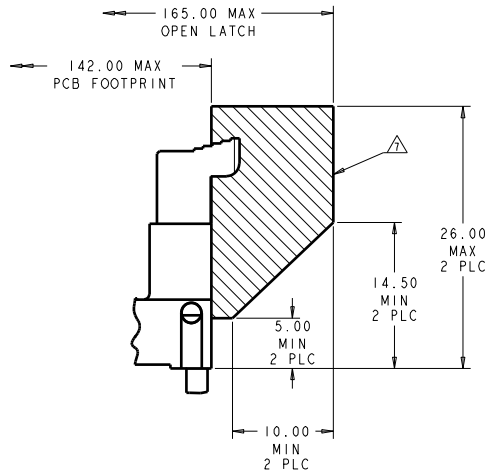

DIMENSIONS: mm		DATE: 04 JAN 2002 BY: J. RINGLER		Tyco Electronics Harrisburg, PA 17105-3608	
DATE: 20 JUN 2003 BY: M. CORRELL		DATE: 04 JAN 2002 BY: J. RINGLER		SOCKET ASSEMBLY, DDR 11 SOLDER TAIL, 240 POSITION	
PRODUCT SPEC		APPLICATION SPEC		SIZE: 00779 DATE CODE: 1489841	
MATERIAL:		FINISH:		WEIGHT:	
CUSTOMER DRAWING		SCALE: 4:1		SHEET 1 OF 3	

REV	DATE	DESCRIPTION	BY	CHK	APP
00		SEE SHEET 1			

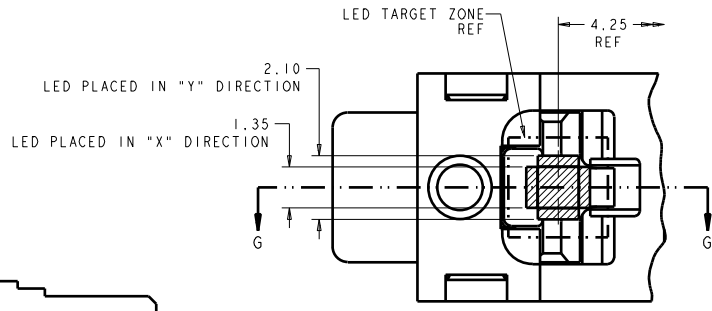

PARTIAL BOTTOM VIEW
 SCALE 12:1

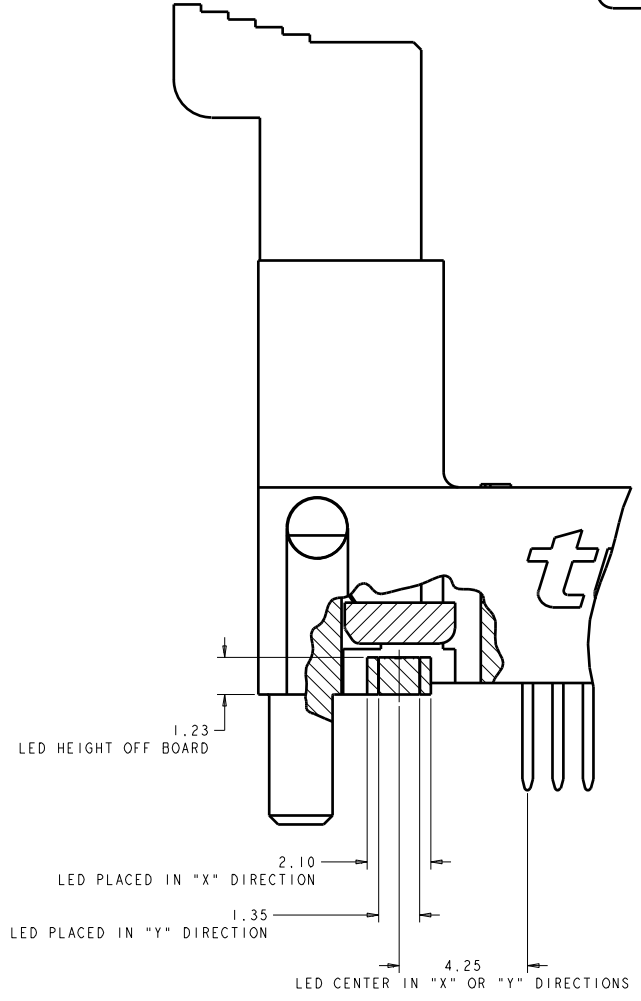

SECTION G-G
 SCALE 12:1

REV	DATE	DESCRIPTION	BY	CHK	APP			
		BLACK	△	0.00038 MIN	3.18	RETENTION BARB	3-1489841-9	△
		BLACK	△	0.00038 MIN	2.67	RETENTION BARB	3-1489841-8	△
		BLACK	△	0.00038 MIN	2.67	RETENTION BARB	3-1489841-7	△
		NATURAL	△	0.00000 MIN	4.00	RETENTION BARB	3-1489841-6	△
		NATURAL	△	0.00000 MIN	3.18	RETENTION BARB	3-1489841-5	△
		NATURAL	△	0.00000 MIN	2.67	RETENTION BARB	3-1489841-4	△
		NATURAL	△	0.00038 MIN	4.00	RETENTION BARB	3-1489841-3	△
		NATURAL	△	0.00038 MIN	3.18	RETENTION BARB	3-1489841-2	△
		NATURAL	△	0.00038 MIN	2.67	RETENTION BARB	3-1489841-1	△
		NATURAL	△	0.00076 MIN	4.00	RETENTION BARB	3-1489841-0	△
		NATURAL	△	0.00076 MIN	3.18	RETENTION BARB	2-1489841-9	△
		NATURAL	△	0.00076 MIN	2.67	RETENTION BARB	2-1489841-8	△
		NATURAL	△	0.00000 MIN	4.00	PLASTIC POST	2-1489841-7	△
		NATURAL	△	0.00000 MIN	3.18	PLASTIC POST	2-1489841-6	△
		NATURAL	△	0.00000 MIN	2.67	PLASTIC POST	2-1489841-5	△
		NATURAL	△	0.00038 MIN	4.00	PLASTIC POST	2-1489841-4	△
		NATURAL	△	0.00038 MIN	3.18	PLASTIC POST	2-1489841-3	△
		NATURAL	△	0.00038 MIN	2.67	PLASTIC POST	2-1489841-2	△
		NATURAL	△	0.00076 MIN	4.00	PLASTIC POST	2-1489841-1	△
		NATURAL	△	0.00076 MIN	3.18	PLASTIC POST	2-1489841-0	△
		NATURAL	△	0.00076 MIN	2.67	PLASTIC POST	1-1489841-9	△
		NATURAL	△	0.00000 MIN	4.00	RETENTION BARB	1-1489841-8	△
		NATURAL	△	0.00000 MIN	3.18	RETENTION BARB	1-1489841-7	△
		NATURAL	△	0.00000 MIN	2.67	RETENTION BARB	1-1489841-6	△
		NATURAL	△	0.00030 MIN	4.00	RETENTION BARB	1-1489841-5	△
		NATURAL	△	0.00038 MIN	3.18	RETENTION BARB	1-1489841-4	△
		NATURAL	△	0.00038 MIN	2.67	RETENTION BARB	1-1489841-3	△
		NATURAL	△	0.00076 MIN	4.00	RETENTION BARB	1-1489841-2	△
		NATURAL	△	0.00076 MIN	3.18	RETENTION BARB	1-1489841-1	△
		NATURAL	△	0.00076 MIN	2.67	RETENTION BARB	1-1489841-0	△
		NATURAL	△	0.00000 MIN	4.00	PLASTIC POST	1489841-9	△
		NATURAL	△	0.00000 MIN	3.18	PLASTIC POST	1489841-8	△
		NATURAL	△	0.00000 MIN	2.67	PLASTIC POST	1489841-7	△
		NATURAL	△	0.00030 MIN	4.00	PLASTIC POST	1489841-6	△
		NATURAL	△	0.00038 MIN	3.18	PLASTIC POST	1489841-5	△
		NATURAL	△	0.00030 MIN	2.67	PLASTIC POST	1489841-4	△
		NATURAL	△	0.00076 MIN	4.00	PLASTIC POST	1489841-3	△
		NATURAL	△	0.00076 MIN	3.18	PLASTIC POST	1489841-2	△
		NATURAL	△	0.00076 MIN	2.67	PLASTIC POST	1489841-1	△
		NATURAL	△	0.00076 MIN	2.67	PLASTIC POST	1489841-0	△
EXTRACTOR COLOR	SOLDER TAIL	CONTACT GOLD INTERFACE	TAIL LENGTH	HOUSING STYLE	PART NUMBER			

DIMENSIONS: mm 1/16" INCREMENTS DECIMALS 0.125 INCHES 1/32" INCREMENTS DECIMALS 0.015 INCHES 1/64" INCREMENTS DECIMALS 0.001 INCHES	DATE: 04JAN2002 BY: D. BINGLER CHECKED: M. CORRELL DATE: 20JUN2003 DRAWN: M. CORRELL	TICO ELECTRONICS HARRISBURG, PA 17105-3608 SOCKET ASSEMBLY, DDR II SOLDER TAIL, 240 POSITION	SHEET: 00779 DRAWING NO: 1489841 RESTRICTED TO:
MATERIAL: FR100		WEIGHT:	CUSTOMER DRAWING:

REV	DATE	DESCRIPTION	BY	CHK	APP
00		SEE SHEET 1			

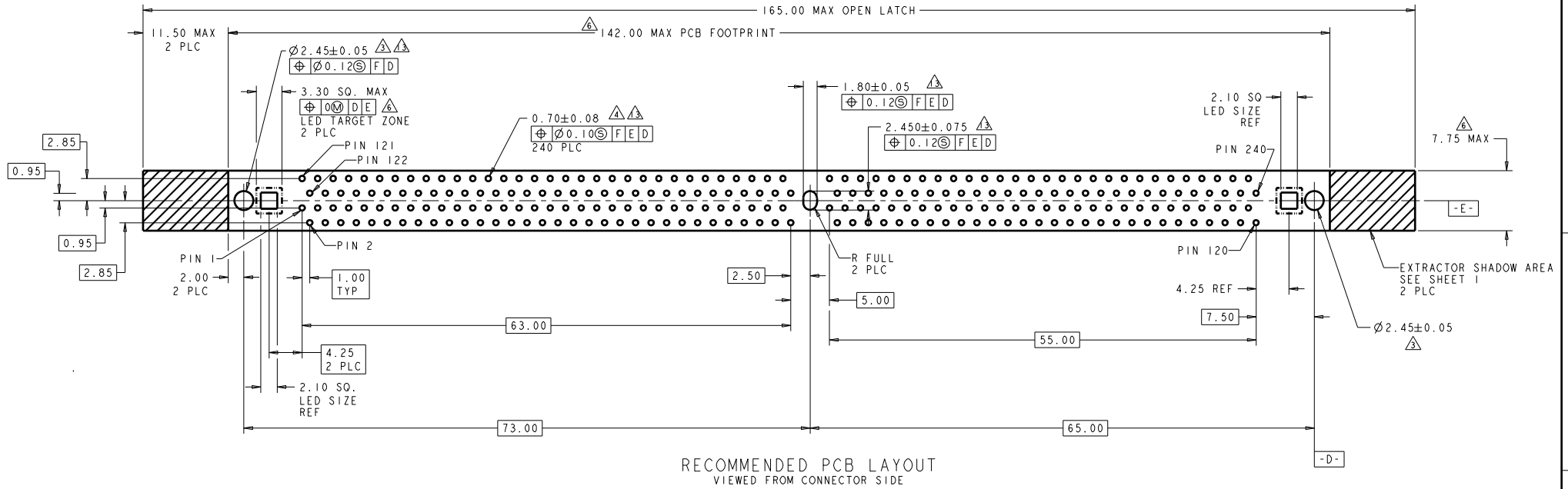

RECOMMENDED PCB LAYOUT
 VIEWED FROM CONNECTOR SIDE

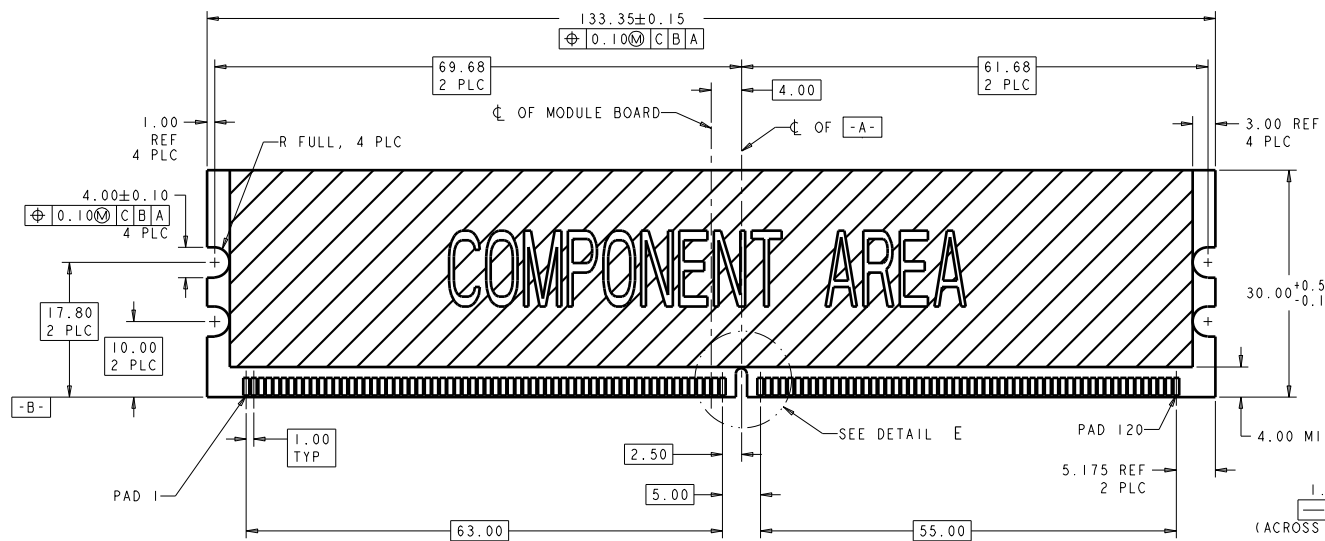

RECOMMENDED MODULE LAYOUT
 SCALE 3:1

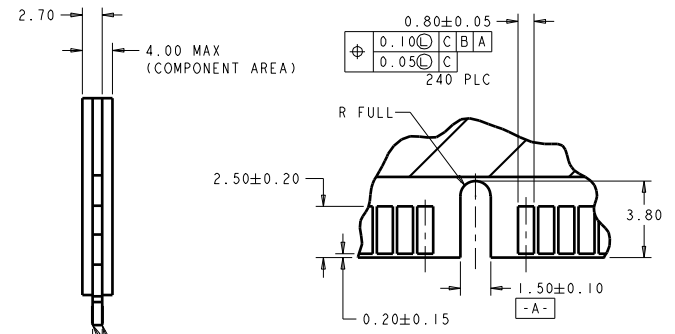

0.20-0.05 X 45° OPTIONAL
 MUST NOT HIT GOLD CONTACTS

DIMENSIONS: mm UNLESS OTHERWISE SPECIFIED: mm DECIMALS: 0.05 ANGLES: AS SHOWN FINISH: AS SHOWN MATERIAL: AS SHOWN		DATE: 04JAN2002 BY: J. BINGLER DATE: 20JUN2003 BY: M. CORRELL	Tyco Electronics Tyco Electronics Harrisburg, PA 17105-3608
PROJECT SPEC: SOCKET ASSEMBLY, DDR II SOLDER TAIL, 240 POSITION APPLICATION SPEC:		SHEET: 00779 CUSTOMER DRAWING:	DRAWING NO: 1489841 SCALE: 1:1 SHEET: 3 OF 3 REV: B